



Applications:

- Validation/Verification
- Presence/Absence
- Identification methods
- ISO 17025 laboratories requiring CRM

Package Details:

- One KWIK-STIK™ – All-in-one design includes a lyophilized microorganism pellet, ampoule of hydrating fluid and inoculating swab
- Certificate of Analysis
- Illustrated Instruction for Use

Highlights:

- Qualitative QC microorganisms just one passage from the reference strains for ultimate authenticity
- For Testing Laboratories, Section 5.6.3.2 of ISO 17025:2005 states: “Reference materials shall, where possible, be traceable to SI units of measurements, or to Certified Reference Materials.”
- Ready-to-use format saves you time and money
- Refrigerated storage is easy and economical
- Traceability to reference cultures ensures authenticity
- Technical Support experts available for guidance

LAB-ELITE CRM ILLUSTRATED INSTRUCTIONS FOR USE

1

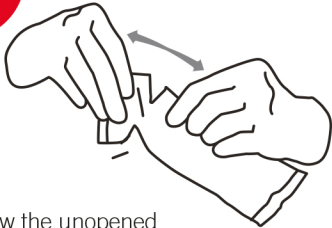

Allow the unopened Lab-Elite™ (KWIK-STIK™) pouch to equilibrate to room temperature. Tear open pouch at notch and remove the KWIK-STIK™ unit.

2

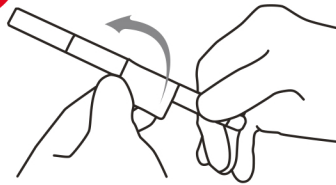

Tear off Pull-Tab portion on the label and attach it to the primary culture plate or QC record. Do not disassemble the device during hydration.

3

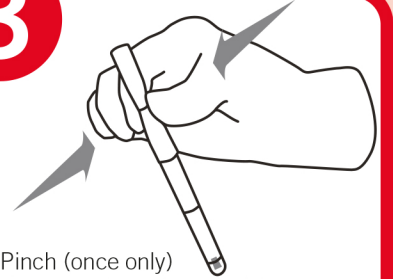

Pinch (once only) the ampoule at the top of the KWIK-STIK™ (just below the fluid meniscus of the ampoule) found in the cap to release the hydrating fluid.

4

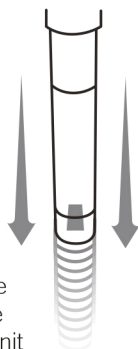

Hold vertically and tap on a hard surface to facilitate flow of fluid through shaft into bottom of unit containing pellet. Allow the hydrating fluid to flow through the swab shaft and into the bottom portion of the unit containing the pellet.

5

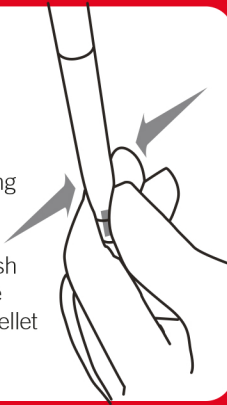

Using a pinching action on the bottom portion of the unit, crush the pellet in the fluid until the pellet suspension is homogenous.

6

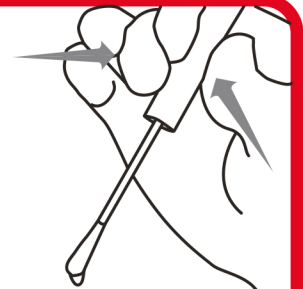

IMMEDIATELY heavily saturate the swab with the hydrated material and transfer to agar medium.

7

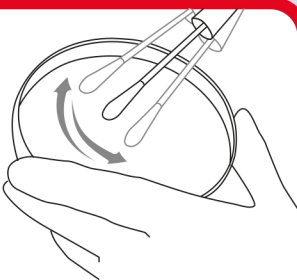

Inoculate the primary culture plate(s) by gently rolling the swab over one-third of the plate.

8

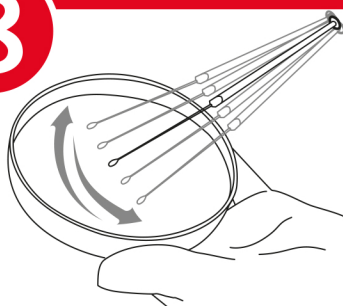

Using a sterile loop, streak to facilitate colony isolation.

9

Using proper biohazard disposal, discard the KWIK-STIK™.



10

IMMEDIATELY incubate the inoculated primary culture plate(s) at temperature and conditions appropriate to the microorganism.